

R E S I D E N C E S

# TRÉSOR

ARTARMON

B Y T R U S L A N

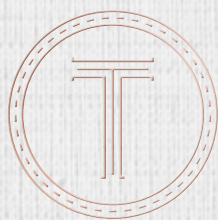



# A UNIQUE LIFESTYLE IN EXQUISITE DETAIL

A collaborative team of some of Australia's leading designers has delivered a collection of exquisitely crafted, beautifully appointed townhomes in a desirable Lower North Shore locale. Celebrated architectural firm Allen Jack+Cottier and interior designers TURNER have created a selection of boutique residences designed to elevate, inspire and bring a new standard of refined luxury to Artarmon.



ARTARMON

Artist's impression only





ARTARMON

Artist's impression only



## LIVING SPACES

Trésor presents a wonderfully unique and versatile offering, providing house-like space and ambience with flexible floorplans accommodating three and four bedrooms. These visionary townhomes have been carefully created to appeal to a variety of buyers, from families and investors to discerning executives and downsizers. Capturing leafy views to the St Leonards skyline, they showcase a meticulously considered design process and can be customised to create the perfect home for your lifestyle.





LOCATION





# BUILD THE LIFE YOU TRULY DESIRE

Courtyards have been created as fluid extensions of the living areas for a seamless transition between the indoors and out. Host your guests, enjoy your morning coffee or just relax and soak up the sunshine in your private, ambiently lit alfresco domain, complete with integrated barbeque stations, sinks and seating to make entertaining effortless.

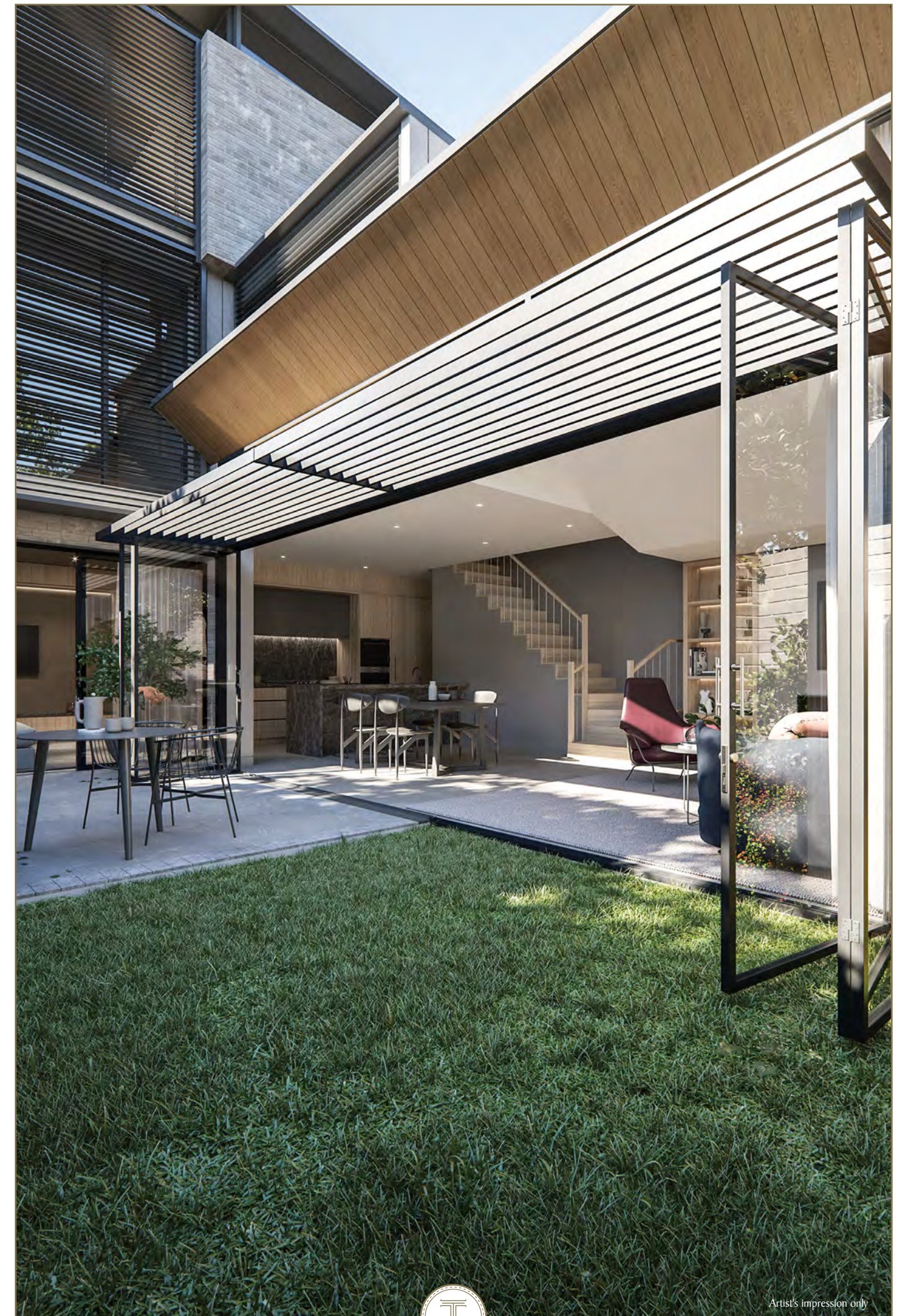





Gas fireplaces and mood lighting make the expansive living spaces an alluring environment for entertaining and family relaxation, framed by bi-folding doors opening to the alfresco areas. Finished with stone floors and rich detailing, they're flooded with natural light throughout the day.

Artist's impression only



BEDROOMS





# ELEGANCE IN THE DETAILS

Bedrooms have been designed as ambient sanctuaries with a luxe appeal and bespoke wardrobes. Fabric-panelled bed heads adorn the master suites, which encompass luxurious ensuite bathrooms with twin vanities and custom-designed dressing rooms.



ARTARMON

Artist's impression only



# KITCHEN INGENUITY



## BUTLER'S PANTRIES

Fashioned with family liveability in mind, many residences encompass butler's pantries off the kitchens, creating dedicated spaces for preparation and storage.



Light Scheme - Canopy

Trésor kitchens are a triumph for those who love to entertain. A beautiful synergy of style and functionality, kitchens are fully integrated for a sleek, modern aesthetic. Encompassing built-in wine fridges, they're finished with textured timber-grained joinery, marble benchtops, sophisticated tapware and premium Miele appliances.

Artist's impression only









Light Scheme - Canopy

Artist's impression only

## BATHROOM INNOVATION



Showcasing clean lines and beautiful finishes, bathrooms exude elegance, with many featuring freestanding baths and double vanities. Timber-accented joinery is complemented by soft LED lighting and mosaic tiled feature walls which vary in shade depending on your chosen colour scheme.





Dark Scheme - Earth

Artist's impression only



# BESPOKE ELEGANCE

## DARK SCHEME EARTH

'Earth' is a darker, moodier scheme with more contrast and depth, pairing smoky hues with rich earthy tones.



## LIGHT SCHEME CANOPY

'Canopy' is a lighter, fresher palette of sandy shades and cool greys for a more subtle effect.



# AN EXTRAORDINARY HOME CRAFTED AROUND YOU



A number of upgrades are available to customise your home to suit your needs and elevate it to a new level. You can elect to upgrade your kitchen appliances, integrate a state-of-the-art Smart Home System or add features such as bespoke wardrobe details.







Artist's impression only

## DELUXE DRESSING ROOMS ADD AN ELEMENT OF PRESTIGE

Generous dressing rooms in the master suites provide the perfect spaces to easily access your attire. Fashioned from beautifully crafted timber joinery, they feature custom touches, refined details and LED lighting.

## FIREPLACES FOR A WELCOMING AMBIENCE

At the heart of the living spaces, gas fireplaces create a wonderfully homely atmosphere and provide an appealing focal point. Set into bold stone foundations, they're surrounded by integrated underlit shelving and TV cabinetry for a streamlined, modern look.



Artist's impression only



LOCATION

# A PERFECTLY SUITED LIFESTYLE

Enjoy the lifestyle you've always envisioned. Laying claim to a wonderfully family friendly lifestyle location within a charming North Shore setting, Trésor enjoys a peaceful, leafy cul-de-sac setting. Discover a thriving local café and restaurant scene, renowned schools, convenient transport, a host of parks and recreational attractions and easy access to a variety of shopping villages and major retail centres such as Chatswood, home to Westfield and Chatswood Chase.





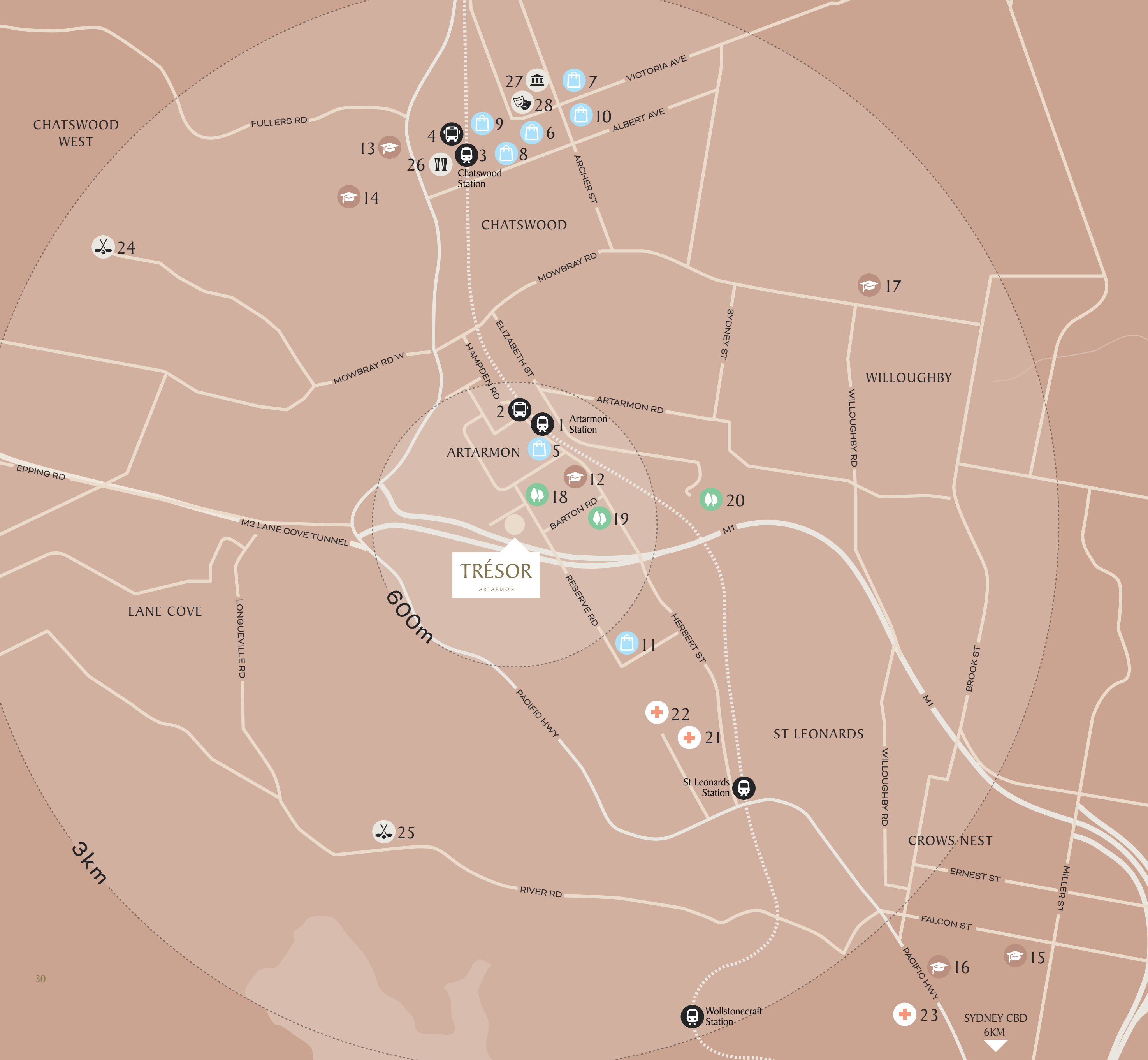

### Transport

1. Artarmon train station (500m)
2. Artarmon bus stop (1.2km)
3. Chatswood train station (2.1km)
4. Chatswood station interchange (2.1km)

### Shopping & Retail

5. Artarmon local retail & shops (500m)
6. Chatswood Westfield (2.2km)
7. Chatswood Chase (2.6km)
8. Chatswood Mandarin Centre (1.9km)
9. Chatswood Station Interchange retail (2.2km)
10. Chatswood local shops (2.2km)
11. HOME HQ (1km)

### Schools

12. Artarmon Public School (300m)
13. Chatswood Public School (2km)
14. Chatswood High School (2.3km)
15. North Sydney Boys High School (3.6km)
16. North Sydney Girls High School (3.2km)
17. Willoughby Girls High School (2.7km)

### Parklands

18. Thomson Park (74m)
19. Cleland Park (500m)
20. Artarmon Reserve (1.2km)

### Hospitals

21. Royal North Shore Hospital (1.8km)
22. North Shore Private Hospital (1.4km)
23. Mater Hospital (3.4km)

### Lifestyle

24. Chatswood Golf Club (3km)
25. Lane Cove Golf Course (2.2km)
26. Chatswood RSL Club (2.5km)
27. Chatswood Library (2.7km)
28. The Concourse, Chatswood (2.3km)



# DINE, DRINK AND SHOP

Artarmon village caters to all of your day to day needs with a number of local shops and amenities. Enjoy a catch up with friends over dinner or grab coffee at the fashionable cafes along Wilkes Avenue, such as local favourites Salvage Coffee, The Wilkes and Everyday Canteen. A number of shopping hubs are in easy reach, including Home HQ for all of your homewares and furniture needs.





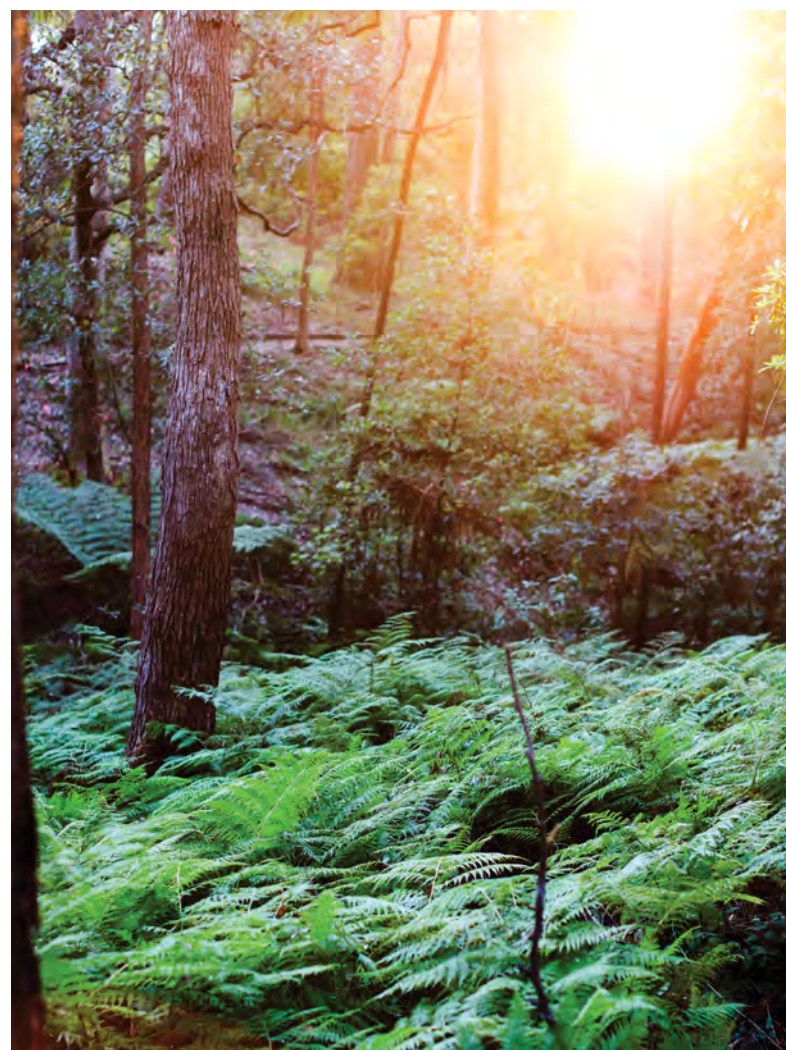
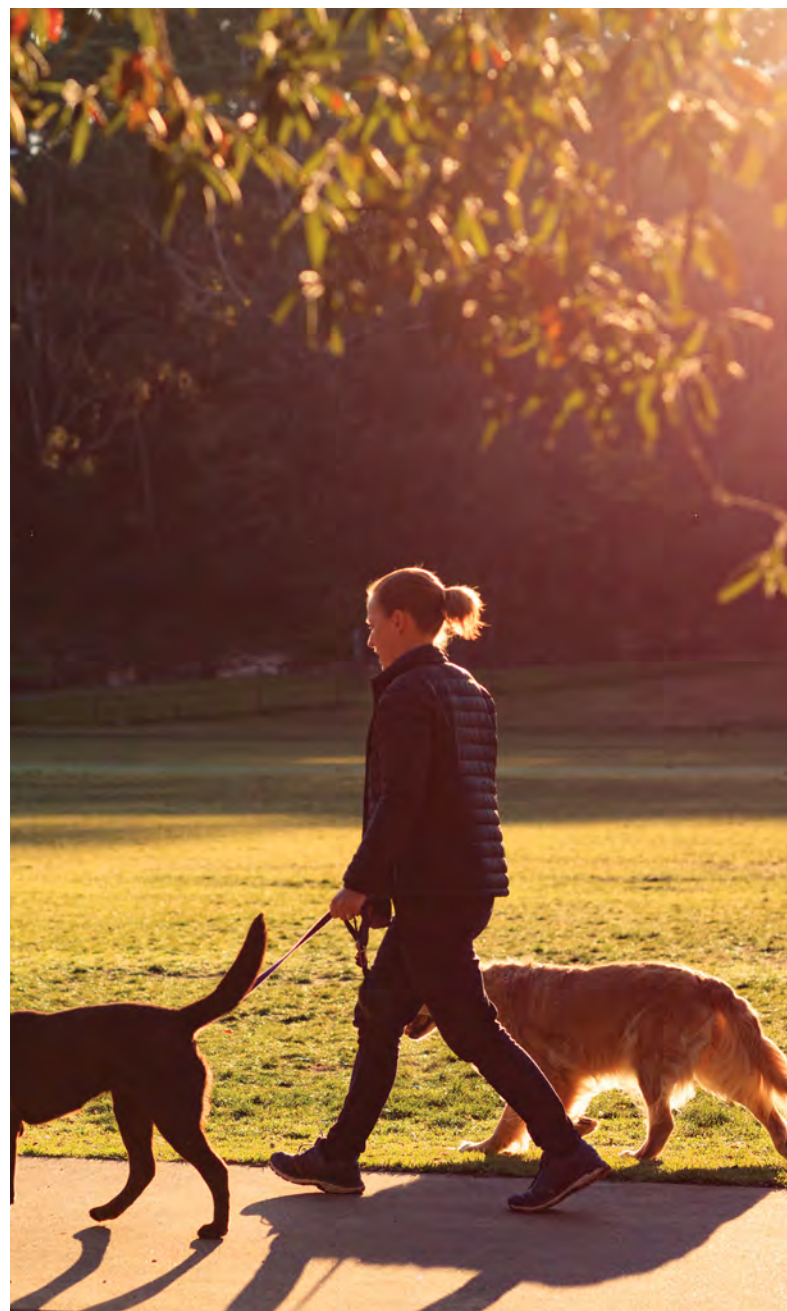

## PARKS AND RECREATION



Artarmon is loved for its leafy streets and abundance of greenery and Trésor is wonderfully connected to this natural environment, with Thomson Park on its doorstep and Cleland Park and Artarmon Reserve close by. Enjoy leisurely walks through bushland trails, take the children to local sporting fields or play a few rounds at one of the many local golf courses.



## TRANSPORT AND CONVENIENCE



Artarmon life is all about ease and convenience. It's just one set of traffic lights to the CBD and close to the Lane Cove Tunnel, the orbital motorway onramp and Pacific Highway, taking you to various reaches of Sydney. Take a brief stroll to Artarmon station and arrive in the CBD in just 16 minutes or utilise the variety of bus routes running along Artarmon's main artery, Hampden Road. The Royal North Shore Hospital precinct also lies within easy walking distance.



## LEADING EDUCATIONAL INSTITUTIONS



The volume of quality schools, both public and private, reflects the family oriented nature of the area. Trésor is a stone's throw from Artarmon Public School, the number one ranking primary school in NSW. It's also conveniently close to North Sydney Boys and North Sydney Girls High Schools and the many leading private schools located in nearby North Sydney.





## DEVELOPER



Truslan Group is an integrated platform offering property services through a specialist network of partners – Truslan Constructions, Truslan PDM and Truslan Estate. The company's aim is to enhance the experience of occupants and in turn create better communities. The group collaborates with specialists across the property sector, with an experienced team providing counsel and guidance to the wider property community to help deliver quality developments. Each Truslan Group project has a precise purpose in society and is built to stand the test of time.

## TURNER INTERIORS



TURNER sees design as a collaborative process, generating environments that both serve their purpose well and bring delight to their occupants. The award-winning firm believes it is important that the buildings they create have lasting qualities that will remain relevant over time.



## ARCHITECT



Combining experience, integrity and innovation, AJ+C's architectural designs continue to change and shape the way people live, work and play. Established in 1952, the firm delivers award-winning urban, interior and heritage projects, covering the full spectrum of architectural and professional services.



# AN ADDRESS TO TREASURE



Trésor has been thoughtfully designed to resonate with buyers on an emotional level by creating an environment that truly feels like home. Life here is refined, inviting and convenient, with a distinct family orientation and room to grow and settle.

No element has been overlooked in the creation of beautiful spaces with an elegant sensibility and a handcrafted feel. The graceful contemporary façade of natural materials such as stone and timber accents ensures the building sits harmoniously within its surroundings. Once inside, the richly detailed interiors achieve a welcoming atmosphere of warmth and luxury.





TRUSLAN  
GROUP

[Tresorbytruslan.com.au](http://Tresorbytruslan.com.au)